

**THE COUNCIL OF THE BOROUGH OF MILTON KEYNES
(THE COUNCIL OF THE BOROUGH OF MILTON KEYNES)
(CENTRAL MILTON KEYNES) (ON-STREET STANDARD RATE PAY
AND DISPLAY AND PAY BY MOBILE PHONE PARKING PLACES AND
VARIOUS PERMITS) ORDER 2005) VARIATION ORDER 2016**

The Council of the Borough of Milton Keynes ("the Council") in exercise of its powers under Sections 1, 32(1), 35(1), 45, 46, 49, 53 and 63 and part IV of Schedule 9 of the Road Traffic Regulation Act 1984 ("the Act of 1984") and of all other enabling powers, and after consultation with the chief officer of Police in accordance with Part III of Schedule 9 to the Act of 1984, hereby makes the following Order:-

PART 1

IMPLEMENTATION AND CIATATION

1. This Order shall come into operation on the 7th day of April 2016 and may be cited as "The Council of the Borough of Milton Keynes (The Council of the Borough of Milton Keynes) (Central Milton Keynes) (On-Street Standard Rate Pay and Display and Pay by Mobile Phone Parking Places and Various Permits) Order 2005) Variation Order 2016".
2. Any reference in this Order to any enactment shall be construed as a reference to that enactment as amended by any subsequent enactment.
3. The plan annexed to this Order identifies the lengths of road subject to this Order, provided that where there is any inconsistency between the plan and Schedules it is the wording of the Schedules which shall prevail.
4. The plan annexed to this Order is hereby annexed to The Council of the Borough of Milton Keynes (Central Milton Keynes) (On-Street Standard Rate Pay and Display and Pay by Mobile Phone Parking Places and Various Permits) Order 2005 and form part of that Order.

MAP FOR ORDER

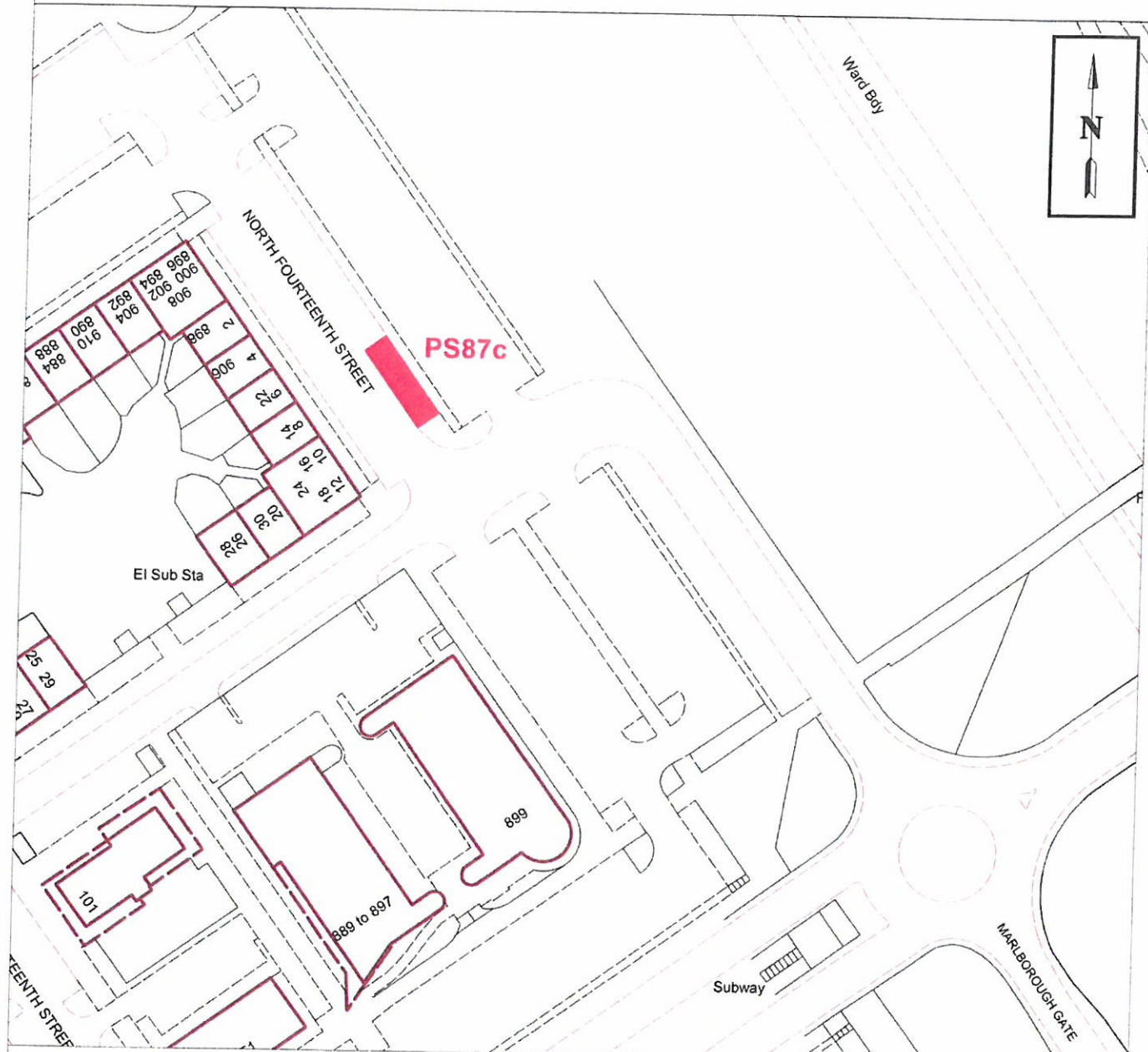

Standard rate pay and display parking places

PS87c

TRO reference

0 2,250



centimeters

Scale: 1:750.0

Map referred to in the Council of the Borough of Milton Keynes
(The Council of the Borough of Milton Keynes) (Central Milton
Keynes) (On-Street Standard Rate Pay and Display and Pay by
Mobile Phone Parking Places and Various Permits) Order 2005)
Variation Order 2016

The Common Seal of the Council of the Borough of Milton Keynes
was hereunto affixed in the presence of:

.....
HEAD OF LEGAL SERVICES



PART 2

VARIATIONS

5. The Council of the Borough of Milton Keynes (Central Milton Keynes) (On-Street Standard Rate Pay and Display and Pay by Mobile Phone Parking Places and Various Permits) Order 2005 ("The Principal Order") is varied as provided by the following provisions of this Order:-
6. Item PS87C in schedule 1 of the Principal Order is revoked and replaced with the following:-

NORTH FOURTEENTH STREET

THE SOUTH-WEST VEHICULAR ACCESSWAY – NORTH-EAST SIDE

PS87c From its junction with the north-western kerbline of the access road leading to Marlborough Gate, continuing for a distance on 25.7 metres in a north-westerly direction

THE COMMON SEAL OF the **COUNCIL
OF THE BOROUGH OF MILTON
KEYNES** was hereunto affixed this 5th day
of April 2016 in the presence of:-

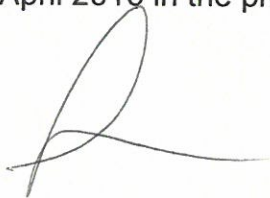

.....
HEAD OF LEGAL SERVICES

